

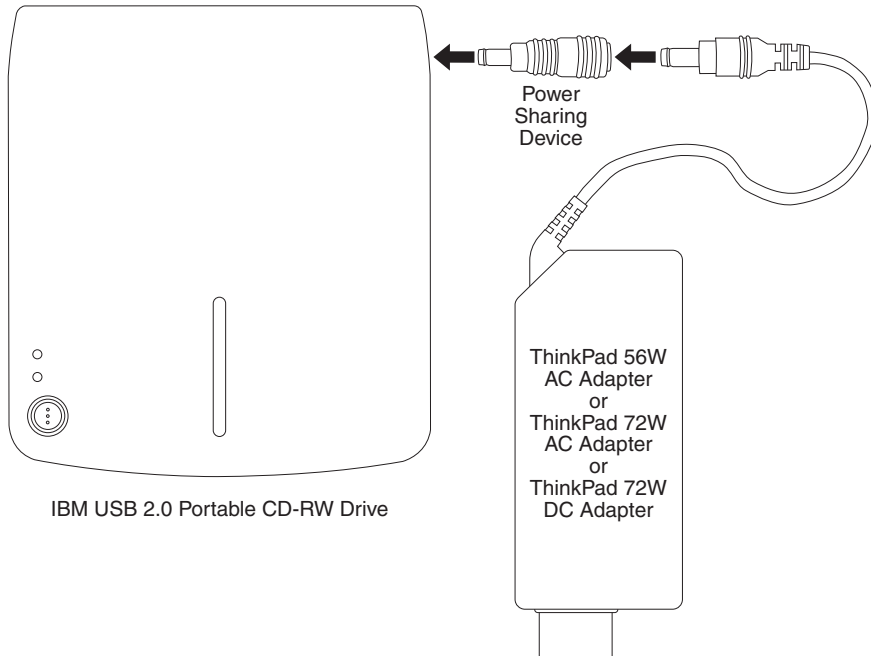

## Important information for the IBM USB 2.0 Portable CD-RW Drive

Either the included power adapter or the power components displayed in the drawing below can be used to power the IBM<sup>®</sup> USB 2.0 Portable CD-RW Drive.



When any audio cable or external speaker system is connected to the LINE OUT jack of the IBM USB 2.0 Portable CD-RW Drive, be sure to attach the provided ferrite core to the cable. Otherwise, the noise from the IBM USB 2.0 Portable CD-RW Drive might cause flickers across your TV screen.

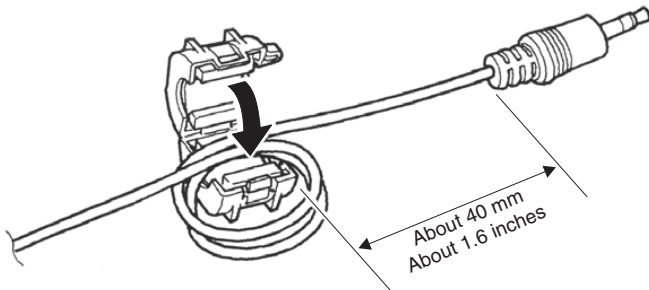

22P6400

© Copyright International Business Machines Corporation 2002.

Note to U.S. Government Users-- Documentation related to restricted rights -- Use, duplication or disclosure is subject to restrictions set forth in GSA ADP Schedule Contract with IBM Corp.

IBM is a trademark of the IBM Corporation in the United States, other countries, or both.

## Wichtige Informationen zum tragbaren IBM USB-CD-RW-Laufwerk 2.0

Für den Betrieb des tragbaren IBM<sup>(R)</sup> USB-CD-RW-Laufwerks 2.0 können entweder das im Lieferumfang enthaltene Netzteil oder die in der folgenden Abbildung dargestellten Netzstromkomponenten verwendet werden.

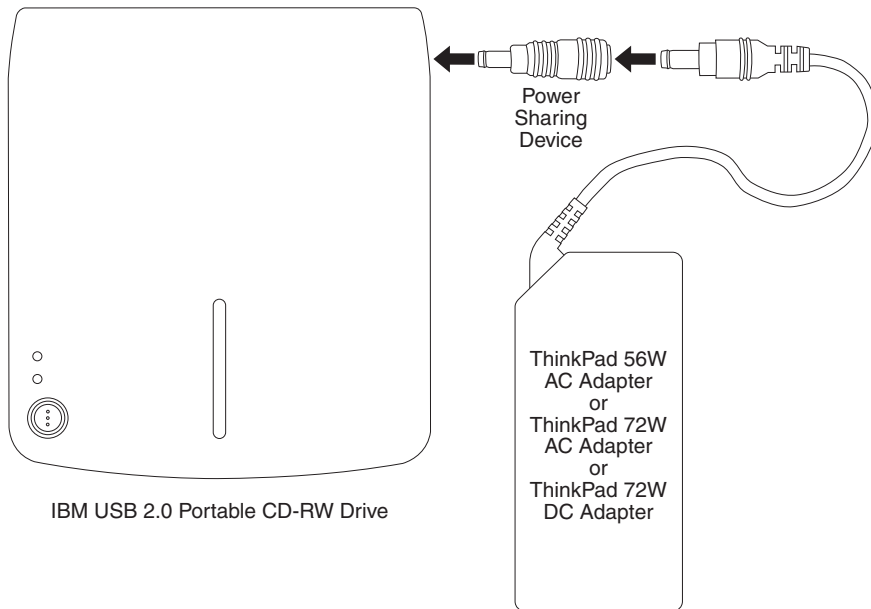

Wenn ein Audiokabel oder ein externer Lautsprecher mit dem Ausgangsanschluss verbunden wird, muss der vorgesehene Ferritkern an das Kabel angeschlossen werden. Andernfalls können die Geräusche, die das tragbare IBM USB-CD-RW-Laufwerk 2.0 verursacht, dazu führen, dass der Bildschirm flimmert.

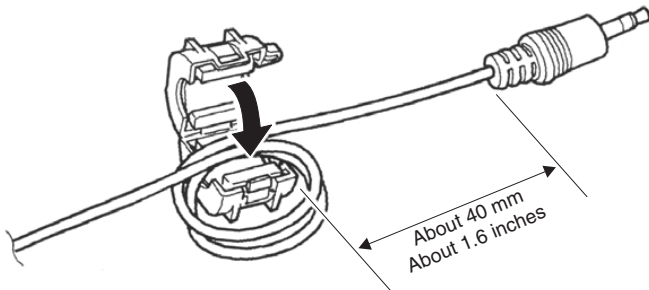

## Unité de CD-RW portable USB 2.0 IBM : Informations importantes

Pour alimenter l'unité de CD-RW portable USB 2.0 IBM, vous pouvez utiliser le bloc d'alimentation fourni ou les éléments présentés dans la figure ci-dessous.

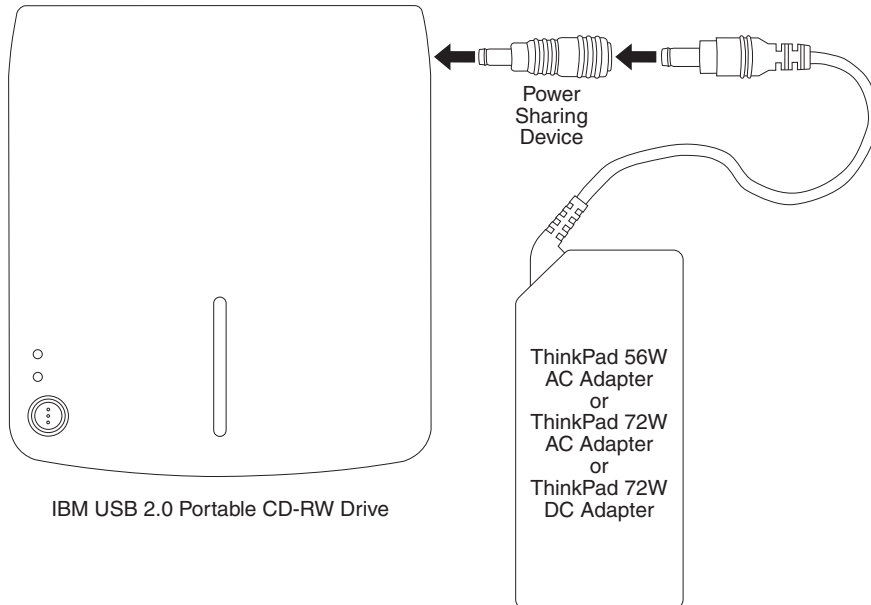

Lorsqu'un câble audio ou un haut-parleur externe est connecté à la prise jack SORTIE LIGNE (LINE OUT) de l'unité de CD-RW, veillez à bien attacher le câble avec le cylindre de ferrite qui est fourni. Sinon, le bruit généré par l'unité de CD-RW pourrait faire scintiller l'écran de votre téléviseur.

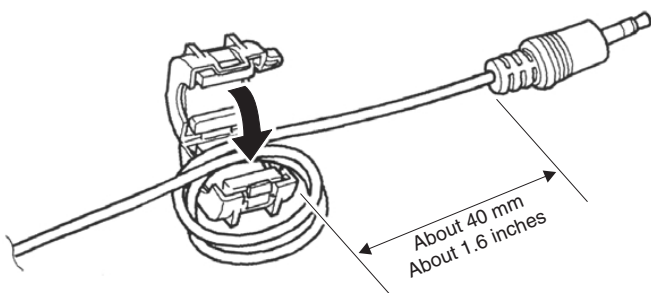

## **Información importante para la unidad de CD-RW portátil USB 2.0 de IBM**

El adaptador de alimentación incluido o los componentes de alimentación mostrados en la ilustración de más abajo se pueden utilizar para proporcionar alimentación a la unidad de CD-RW portátil USB 2.0 de IBM <sup>(R)</sup>.

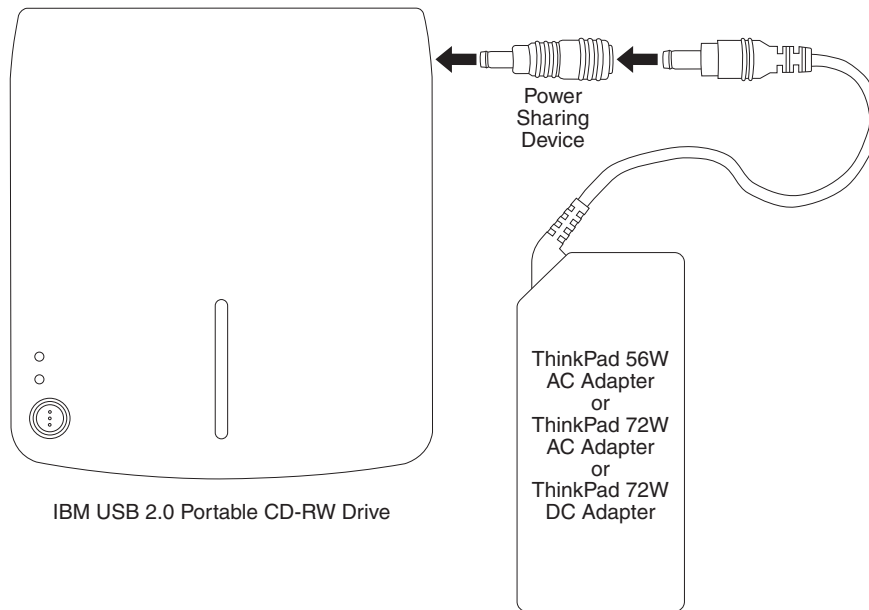

Cuando el cable de audio o el sistema de altavoces externos está conectado al conector de SALIDA DE LÍNEA de la unidad de CD-RW portátil USB 2.0 de IBM, asegúrese de conectar el núcleo de ferrita proporcionado al cable. Si no lo hace, es posible que el ruido de la Unidad de CD-RW portátil USB 2.0 de IBM cause parpadeos en la pantalla del televisor.

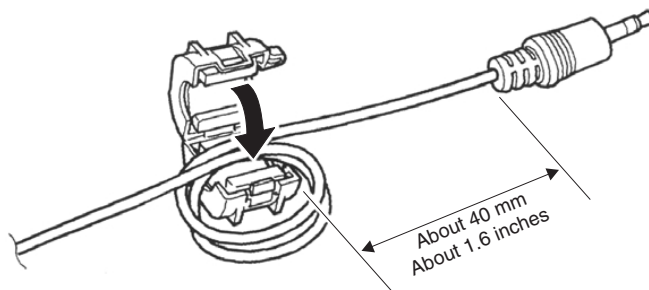

## **Informazioni importanti per gli utenti di IBM USB 2.0 Portable CD-RW Drive**

L'adattatore di rete e i componenti visualizzati nell'immagine seguente possono essere utilizzati per alimentare l'IBM<sup>(R)</sup> USB 2.0 Portable CD-RW Drive.

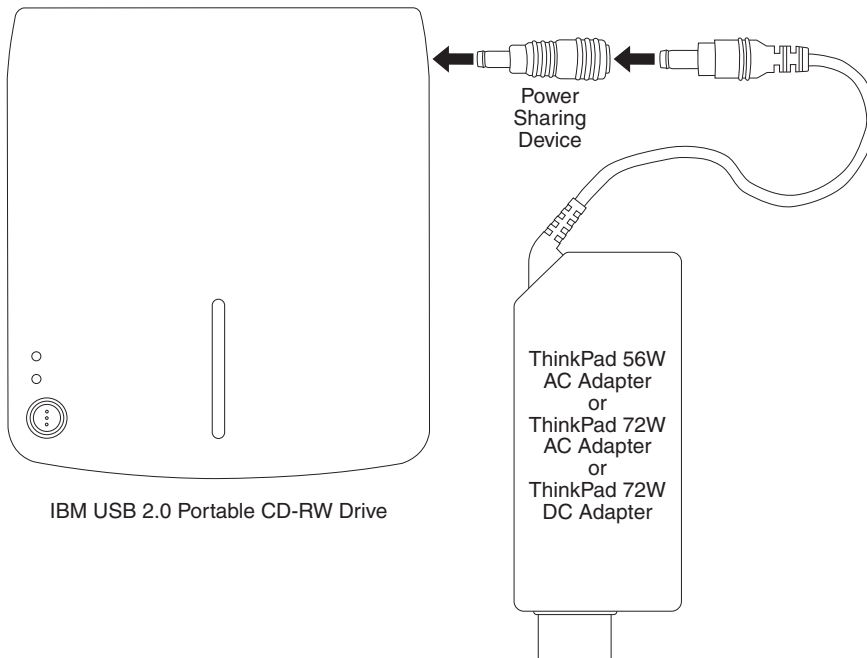

Quando un cavo audio o un sistema di altoparlanti esterno viene collegato alla presa LINE OUT dell'IBM USB 2.0 Portable CD-RW Drive, accertarsi di connettere al cavo il nucleo di ferrite fornito. In caso contrario, è possibile che il ronzio proveniente dall'IBM USB 2.0 Portable CD-RW Drive causi uno sfarfallio negli schermi televisivi.

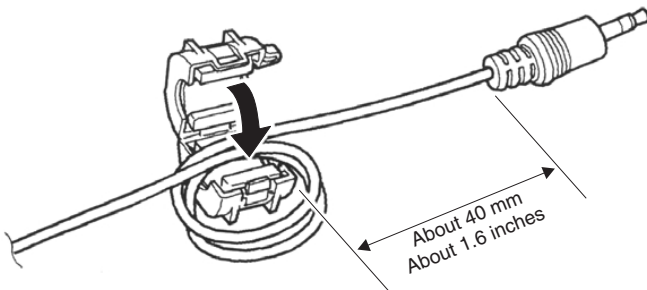

## **Informações importantes sobre a Unidade CD-RW Portátil IBM USB 2.0**

Tanto o adaptador quanto os componentes de alimentação incluídos, exibidos no desenho a seguir, podem ser utilizados para ativar a Unidade CD-RW Portátil IBM<sup>(R)</sup> USB 2.0.

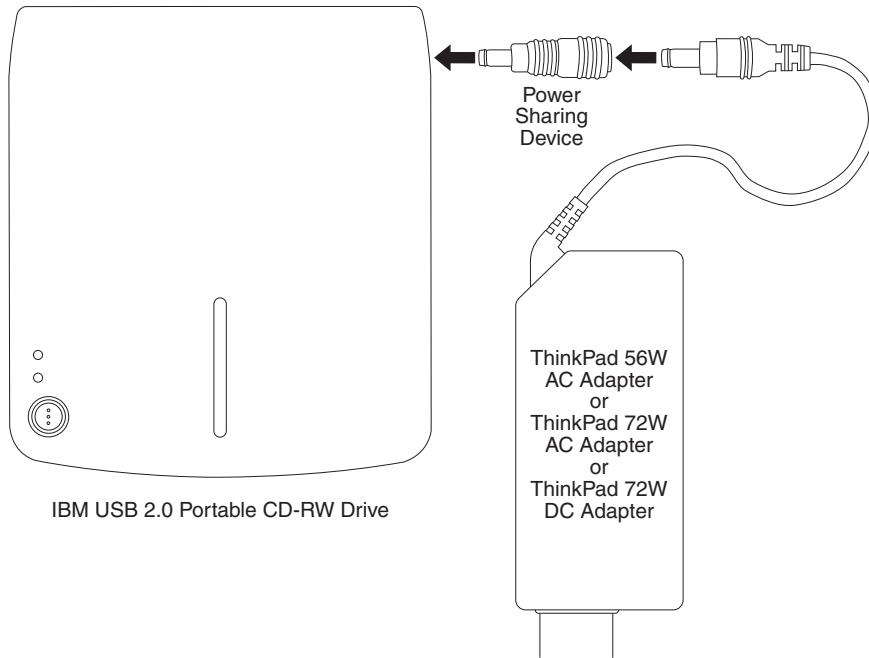

Quando qualquer cabo de áudio ou sistema de alto-falantes externo for conectado à tomada LINE OUT da Unidade CD-RW Portátil IBM USB 2.0, certifique-se de conectar ao cabo o núcleo de ferrita fornecido. Caso contrário, o ruído da Unidade CD-RW Portátil IBM USB 2.0 poderá causar oscilações na tela de sua TV.

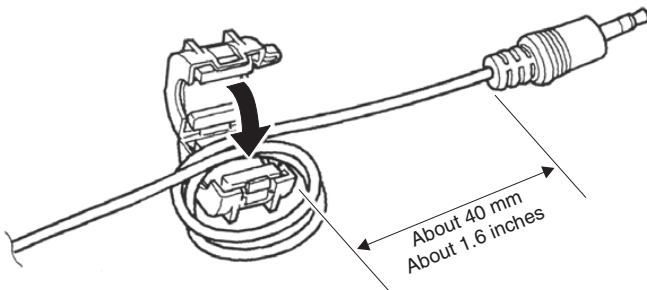

## IBM USB 2.0 可攜式 CD-RW 光碟機重要資訊

不論是電源整流器或是下列圖示所示的電源元件，皆可以用來啓動 IBM® USB 2.0 可攜式 CD-RW 光碟機的電源。

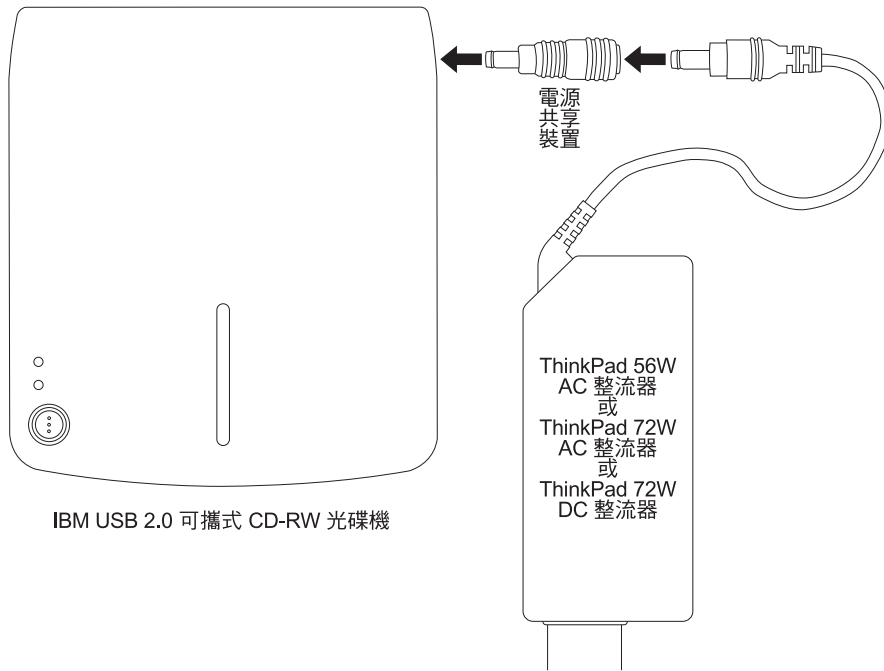

當任何音訊線或外接式喇叭系統連接到 IBM USB 2.0 可攜式 CD-RW 光碟機的 LINE OUT 插孔時，請確定所提供的電源濾波器有裝上接線。否則，IBM USB 2.0 可攜式 CD-RW 光碟機的雜訊，會導致您的 TV 螢幕出現閃爍。

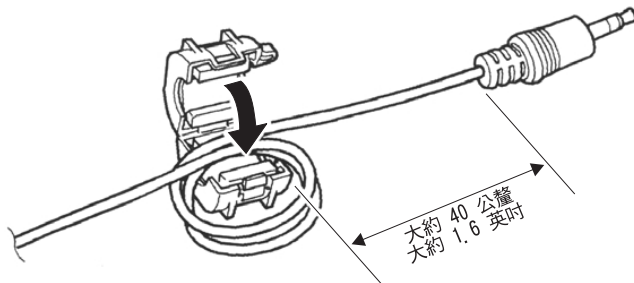

## IBM USB 2.0 ポータブル CD-RW ドライブに関する重要なお知らせ

下図に示されている電源アダプターまたは部品は、IBM<sup>(R)</sup> USB 2.0 ポータブル CD-RW ドライブの電源に使用できます。

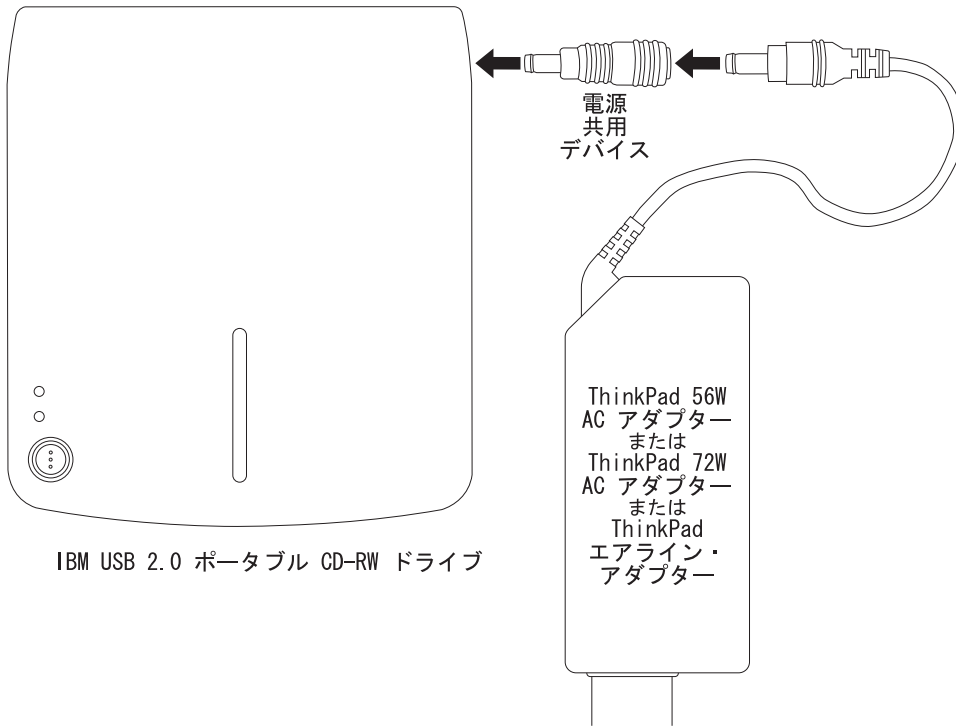

IBM USB 2.0 ポータブル CD-RW ドライブの出力ジャックに接続されているオーディオ・ケーブルまたは外付けスピーカーは、必ず、付属のフェライト・コアをケーブルに接続してください。そうしないと、IBM USB 2.0 ポータブル CD-RW ドライブの雑音は、TV 画面のちらつきの原因となることがあります。

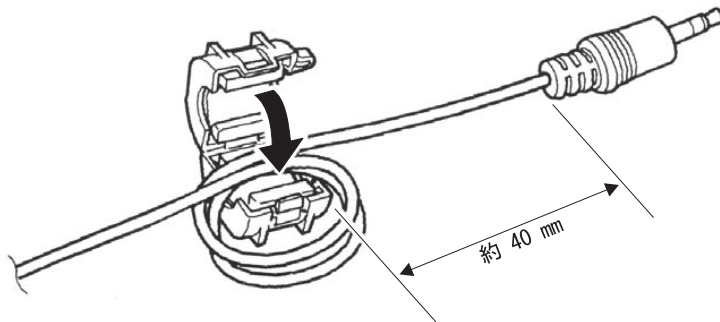

22P6400

© Copyright International Business Machines Corporation 2002.

Note to U.S. Government Users-- Documentation related to restricted rights -- Use, duplication or disclosure is subject to restrictions set forth in GSA ADP Schedule Contract with IBM Corp.

IBM is a trademark of the IBM Corporation in the United States, other countries, or both.



\*22P6400\*